

A project by



LIVING
IS IN THE
DETAILS



FOR LIVING, RIVERSCAPE

Riverscape fills the gap of smart and purposeful living with riverside homes that enhance the idea of life. Completing this story with remarkable details that just keep giving more of everything.

At Riverscape
Living is In Details.

22.5 Acres

226 - East & West Facing Villas

47,000 Sq. Ft. Clubhouse

Sports and Play Facilities

IGBC Gold Pre-Certified Community

Walking track overlooking the river

Landscaped outdoor spaces

Located in the developed area of Bandlaguda

FOR SMART SPACES, WE ADDED MODERN & EFFICIENT LIFE

Thoughtfully incorporated with the latest home technology and smart controls, every home at Riverscape is designed to provide additional comfort and efficiency in every room.

Heightened Ceilings

Lift for every home

30% Glass Cover

Levelled pathway for pedestrians' ease





FOR A PALACE OF JOY, WE HAVE A CLUBHOUSE OF 47,000 SQ. FT.

Club Scape

Crèche

Convenience Store

Business Center

Guest Rooms

Taproom

Infinity Pool

Banquet Hall

Party Lawns

Indoor/Outdoor Yoga

Spa

Outdoor Gazebo Sit Outs

Sports Viewing Gallery

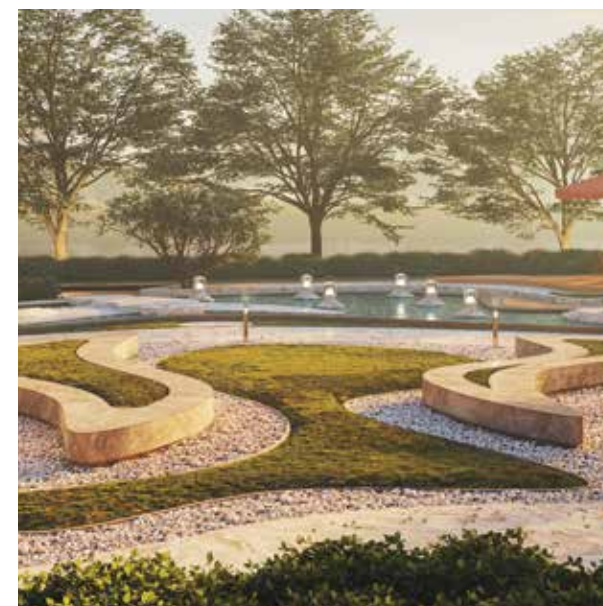



FOR AN ACTIVE LIFESTYLE, WE ADDED SPORTS AND PLAY

Two Badminton Courts

Squash Court

Basketball Court

Lawn Tennis

Beach Volleyball

Rooftop Astro Football Turf

Two Cricket Net Practice

1.4 Km Jogging Track

Swimming Pool

Indoor Games

Gym





200 EAST
Total Built-Up Area 3400 Sft

Ground Floor
1227 Sft

First Floor
1227 Sft

Second Floor
946 Sft

200 WEST
Total Built-Up Area 3256 Sft

Ground Floor
1175 Sft

First Floor
1175 Sft

Second Floor
906 Sft





230 WEST
Total Built-Up Area 3860.5 Sft

Ground Floor 1376.75 Sft | First Floor 1376.75 Sft | Second Floor 1107 Sft

230 EAST
Total Built-Up Area 3915 Sft

Ground Floor 1437.56 Sft | First Floor 1437.56 Sft | Second Floor 1040 Sft







300 EAST

Total Built-Up Area 4850 Sft

Ground Floor
1552 Sft

First Floor
1649 Sft

Second Floor
1649 Sft

300 WEST

Total Built-Up Area 4826 Sft

Ground Floor
1554 Sft

First Floor
1636 Sft

Second Floor
1636 Sft



AERIAL VIEW



FOR MASTER PLAN, WE ADDED A GRAND LIVING

Legend

1. Entry/Exit Gate
2. Driveway
3. Mini Garden
4. Temple
5. Tennis Court
6. Beach Volleyball Court
7. Cricket Practice Net
8. Basket Ball Court
9. Kid's Play Area
10. Gazeboo Sitout
11. Dog's Park/Seating Deck
12. Open Party Lawn
13. Yoga I Meditation Deck
14. Walking Track
15. Clubhouse
16. Services Yard
17. Deck
18. Water Body





FOR
CONVENIENCE,
WE HAVE A WELL-
CONNECTED
NEIGHBOURHOOD

@ BANDLAGUDA

One of Hyderabad's youngest and most exciting areas, Bandlaguda Jagir is also perhaps the city's greenest zone. Featuring world-class amenities for sports and shopping, Bandlaguda is also home to Himayat Sagar as well as the 700 acre Mrugavani National Park - a green lung space unlike any other in the city.



Urban League is a company of experienced professionals in real estate with technology & nature-driven projects that are progressive. With 20+ years of experience in varied fields such as real estate, finance, design and execution, the company has a strong vision for every project to stand out as a landmark. Riverscape, the first prestigious project of Urban League, is bringing together the best design, breathtaking details and impeccable execution to deliver only the perfect home to you and your family.

A WORD FROM THE MANAGEMENT

It gives us great pride and joy to present you with Riverscape. Every aspect of this project is designed to reimagine life in an urban setting. While pushing the boundaries of design and architecture, Riverscape is built to present a reimagined life surrounded by nature's best while still being located in the heart of the city.

OUR CONSULTANTS





RERA NO: P02400004424